



# INSTALLATION MANUAL

## TABLE OF CONTENTS

|  |    |  |    |
|--|----|--|----|
| <b>Warning Labels and Indicators</b> .....           | 3  | <b>Installation Completion Checklist</b> ..... | 20 |
| <b>Pre-Installation Notice</b> .....                 | 4  | <b>Appendix</b> .....                          | 21 |
| <b>System Overview</b> .....                         | 5  | Torque Table .....                             | 21 |
| Understanding Your AmeriDeck® .....                  | 5  | <b>Diagrams</b> .....                          | 22 |
| Lift Arm .....                                       | 5  | System Diagram .....                           | 22 |
| Base Length .....                                    | 5  | System Diagram with Wireless Pendant .....     | 22 |
| <b>System Requirements</b> .....                     | 6  | Wireless Control Pendant Wiring .....          | 23 |
| Required Items Not Supplied in Installation Kit. . . | 6  | <b>Parts and Components</b> .....              | 24 |
| Required Tools for Assembly/Installation .....       | 6  | <b>Parts Diagram</b> .....                     | 25 |
| <b>Installation Kit Components</b> .....             | 7  | <b>Troubleshooting</b> .....                   | 26 |
| Common Installation Kit .....                        | 7  | <b>Notes</b> .....                             | 27 |
| Electric Installation Kit .....                      | 7  |  |    |
| Mounting Kit .....                                   | 7  |  |    |
| Optional Accessories .....                           | 7  |  |    |
| <b>Pre-Installation</b> .....                        | 8  |  |    |
| Product Overview .....                               | 8  |  |    |
| Disconnect the Battery .....                         | 8  |  |    |
| Dismount Assembled Truck Mount .....                 | 9  |  |    |
| <b>Installation</b> .....                            | 11 |  |    |
| Bed/Box Installation Notices .....                   | 11 |  |    |
| Bed/Box Installation .....                           | 12 |  |    |
| Welding the Leveling Feet Procedure .....            | 15 |  |    |
| Bolting the Leveling Feet Procedure .....            | 15 |  |    |
| Installation of Ground Wire .....                    | 16 |  |    |
| Installation of the Circuit Breaker .....            | 16 |  |    |
| FMVSS Camera Compliance .....                        | 17 |  |    |
| Lubricate the Lift System .....                      | 17 |  |    |
| Prime the Hydraulic System .....                     | 18 |  |    |
| Remove the Lift Arm .....                            | 18 |  |    |
| Attach the Lift Arm .....                            | 18 |  |    |
| <b>Optional Installations</b>                        |    |  |    |
| Wireless Remote Control Pendant .....                | 19 |  |    |



## WARNING LABELS AND INDICATORS

**DANGER**

Indicates a hazardous situation that, if not avoided, could result in serious injury or even death

**CAUTION**

Indicates to hazardous situations that, if not avoided, could result in minor to moderate injury

**WARNING**

Indicates to hazardous situations that, if not avoided, could result in minor to severe injury

**NOTICE**

Indicates information considered important, but not hazard-related

**DANGER**

Be sure to wear appropriate eye or face protection when exposed to eye or face hazards from flying particles, molten metal, liquid chemicals, acids or caustic liquids, chemical gases or vapors, or potentially injurious light radiation.

**DANGER**

Damage to the brake lines during equipment installation, or installing bolts or equipment in such a way that a line will rub and become damaged can lead to failure of the brakes, which can lead to severe injury or death. Always take adequate steps to prevent brake line damage during installation and isolate brake lines from installed equipment.

**DANGER**

Welding, oxygen-fuel cutting, or grinding sparks can cause fuel to ignite which in turn can lead to injury or death. Always take adequate steps to avoid ignition of fuel from fuel tanks when welding, oxygen-fuel cutting or grinding during equipment.

**DANGER**

Heat from the trucks' exhaust system can cause hydraulic component failure and may lead to a fire which could cause injury or death. Always install equipment in locations where heat from the exhaust will not damage any hydraulic component.

**WARNING**

Failure to install or operate the AmeriDeck® Lift System, as described in Installation or Operation Manual may result in a faulty component or malfunction, and may void vehicle or AmeriDeck® warranty, and or may cause serious injury.

**WARNING**

During installation or assembly components or material handling that may be heavy ensure to use proper equipment or additional assistance for lifting. Failure to properly lift or carry loads that are either too large or too heavy may result in serious injury.

## PRE-INSTALLATION NOTICE

### **Read and Understand the Installation Manual Thoroughly Before Installation of the AmeriDeck® Hoist System**

#### **NOTICE**

Installation of the AmeriDeck® lift system is not complete until the installer has verified the lift system is fully tested. Once the system is working as intended, complete the installation completion checklist, located in the back of this manual. Review AmeriDeck® operator manual and vehicle manufacturer owner manual before using the system, as this may result in injury or loss of vehicle and/or system if not done correctly.

#### **NOTICE**

Installation of an AmeriDeck® lift system to the bed/box of a truck will change the center of gravity. Please refer to proper vehicle handling techniques when navigating turns and traveling on uneven ground.

#### **NOTICE**

The maximum lift capacity for the AmeriDeck® system is 2500 lbs. Legal payload for the system is calculated on a case-by-case basis using the specific truck GVWR and truck weight. It is up to the user, not AmeriDeck®, to install and use the system responsibly.

## SYSTEM OVERVIEW

### Understanding Your AmeriDeck®

Before installing the AmeriDeck® lift system, please review and understand the hoist system. The serial/model identification tag is located in different places for the Lift System™, PowerDeck™, and DumpDeck™.

#### Lift System™

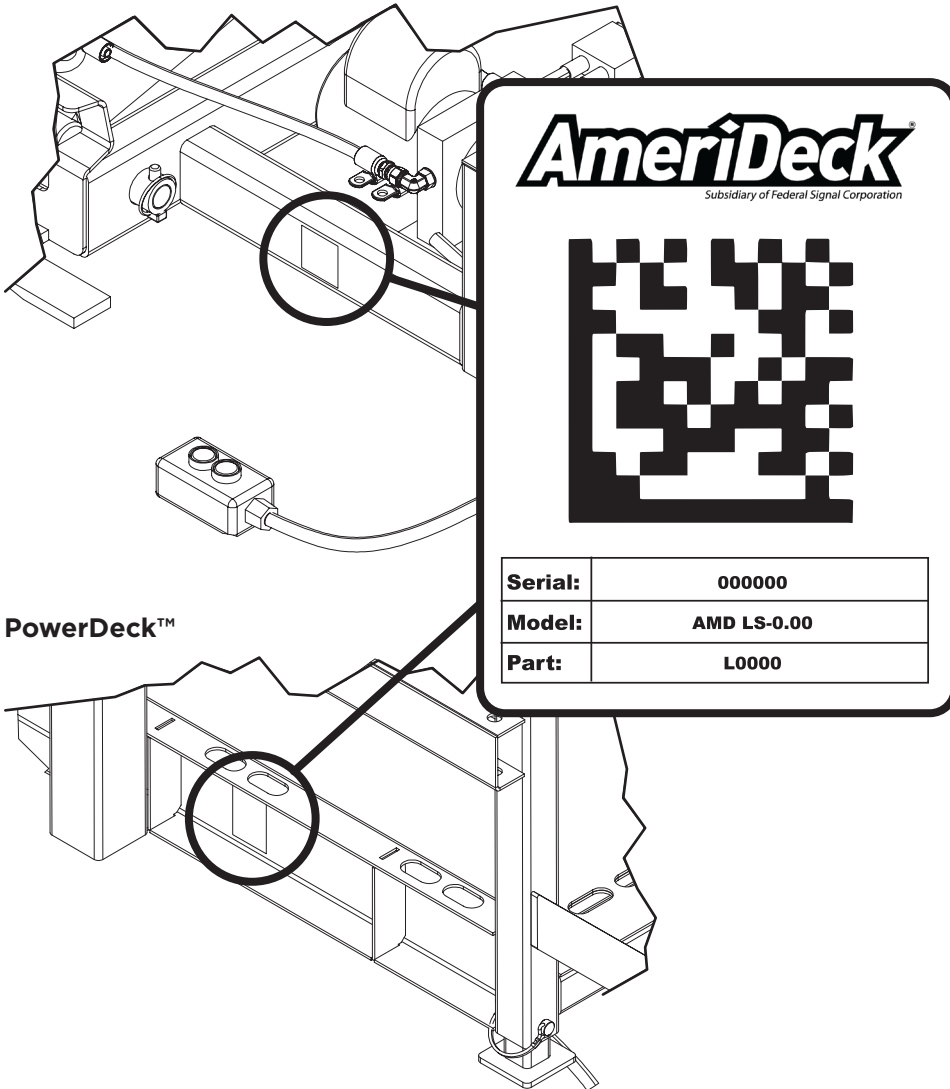

#### SERIAL

A unique number that is specific to each model based on manufacture date and sales order. It is used for any warranty claims or technical support.

#### MODEL

A generic model number for the product you purchased.

**AMD:** Identifies this as an AmeriDeck™ product

**LS:** Indicates which AmeriDeck® model/product

**0.00:** Model length in feet

#### PART

Identifies product specifications internally at AmeriDeck®.

### Lift Arm

The AmeriDeck® Lift System is intended to fit inside the bed/box of a class 1, 2, or 3 or GVWR of 6,000 - 16,000 lb vehicles. For additional information see your vehicle manufacturer's up-fit documents.

### Base Length

The AmeriDeck® Lift System base is available in 8' and 6.5' lengths and is designed to fit in truck beds from 6'4" to 8' long.

## SYSTEM REQUIREMENTS

### **NOTICE**

The AmeriDeck® lift system is a hydraulic loading system that has an electric powered hydraulic pump cylinder. The AmeriDeck® lift system comes pre-installed with the hydraulic hoses from the hydraulic pump to the hydraulic pump cylinder. The installer is responsible for testing that the batteries and alternator are functioning properly and meet the system requirements as stated below. Failure to meet the requirements may result in a weak or non-functioning system.

### **NOTICE**

AmeriDeck® lift systems new installations require priming before operation to avoid the possibility of pump damage or failure. The AmeriDeck® system ships filled with fluid already in it, but to ensure that there is no air in the hydraulic lines, you may need to prime the system. The reservoir maximum capacity of hydraulic oil is 1.19 gallons.

### **NOTICE**

The maximum lift capacity for the AmeriDeck® system is 2500 lbs. Legal payload for the system is calculated on a case-by-case basis using the specific truck GVWR and truck weight. It is up to the user, not AmeriDeck®, to install and use the system responsibly.

## Required Items Not Supplied in Installation Kit

- One standard duty alternator with a minimum rating of 50AMP
- One standard duty battery with a minimum Cold Cranking Amps (CCA) rating of 500 AMPs
- Extra hydraulic oil equivalent to Grade 32 (such as ATF-Dextron II or Mobile DTE 13)

## Required Tools for Assembly/Installation

- Drill
- Hammer
- 9/16" drill bit
- Phillips driver bit
- 5/16" hex driver
- 1/2" hex driver
- 3/4" socket and combination wrenches (1)
- 1/2" combination wrenches (2)
- Sharp knife

## INSTALLATION KIT COMPONENTS

### Common Installation Kit

#### Manuals

- (1) Installation Manual
- (1) Operator Manual

#### Lift System Components

- (1) Lift Arm Assembly
- (1) Base Assembly

#### Controller/Pendant

- (1) Control Pendant with 4' Cord with 2-pole disconnect

#### Small Parts

- (5) Ø 1/4" x 1" Self Drilling Screws
- (5) Rubber Loop Straps
- (4) Ø 5/16" x 1" Self Drilling Screws

### Mounting Kit

Before installation of the AmeriDeck® system, please determine the length of the bed/box.

- (2) Pre-bent Mounting Bracket with Welded-In Nuts
- (1) 16" Mounting Bracket with Welded-In Nuts
- (1) 7" Mounting Bolt
- (3) Ø 1/2" 13 UNC x 2 1/2" HHCS Grade 5 Bolt
- (3) Ø 1/2" Flat Washer
- (3) Ø 1/2" Lock Washer
- (1) 25' Roll of Polyethylene Foam
- (1) Sign Plate
- (4) 1/4" x .75" Self Drilling Screws
- (2) Predrilled Self Leveling Feet

### Electric Installation Kit

#### Electrical Wires

- (1) Battery/Circuit Wire - #2 AWG (18" length)
- (1) Power/Ground 48" Section (attached to pump)
- (1) Power/Ground 20' Section

#### Electrical Hardware

- (1) 150 AMP Circuit Breaker

### Optional Accessories

The optional AmeriDeck® components are not required but may require additional modification.

#### Wireless Remote Control

- (1) Wireless Remote Control Pendant & Kit with 10 AMP In-Line Fuse and Antenna - PN 3190120

## PRE-INSTALLATION

### Product Overview

For more complete assembly, see system list and diagram on pages 25-26.

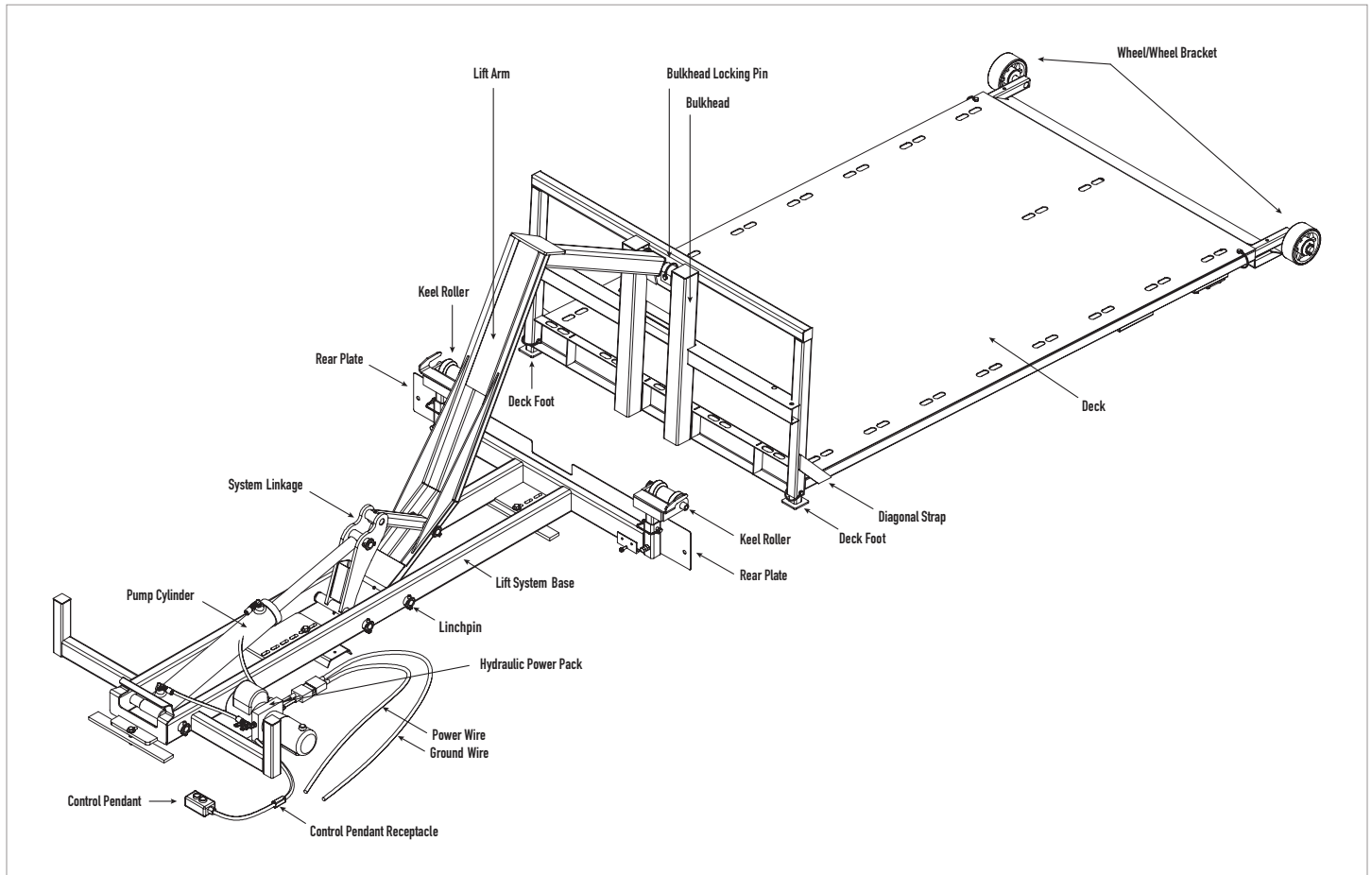

Figure 1.A

### Disconnect the Battery

- Step 1** — Place the vehicle on level ground with room to work around it.
- Step 2** — Set vehicle transmission in park (P) position and set the parking brake.
- Step 3** — Turn off vehicle by either turning the key or pressing the vehicle start/stop button.
- Step 4** — Disconnect the (-) cable by safely loosening the connector nut on the battery terminal. Repeat this process for the additional battery.
- Step 5** — Disconnect the (+) cable by safely loosening the connector nut on the battery terminal. Repeat this process for the additional battery.



### **DANGER**

Do not allow battery terminals to come in contact with either the truck components or vehicle chassis frame as this could cause a short circuit, damage to vehicle computer and result in fire or serious damage, injury or death.



## PRE-INSTALLATION

### Dismount Assembled Truck Mount

#### **! NOTICE**

In most cases the deck is purchased with a deck mounted to the lift system and must be dismantled from the lift system to install the system.

#### **! NOTICE**

The lift system must return to its original retracted position as shipped without the deck mounted to allow for proper access for drilling of the mounting brackets when placed in the rear of the truck bed/box. The system is supplied with a hydraulic pump, cylinder and pre-installed hydraulic hoses.

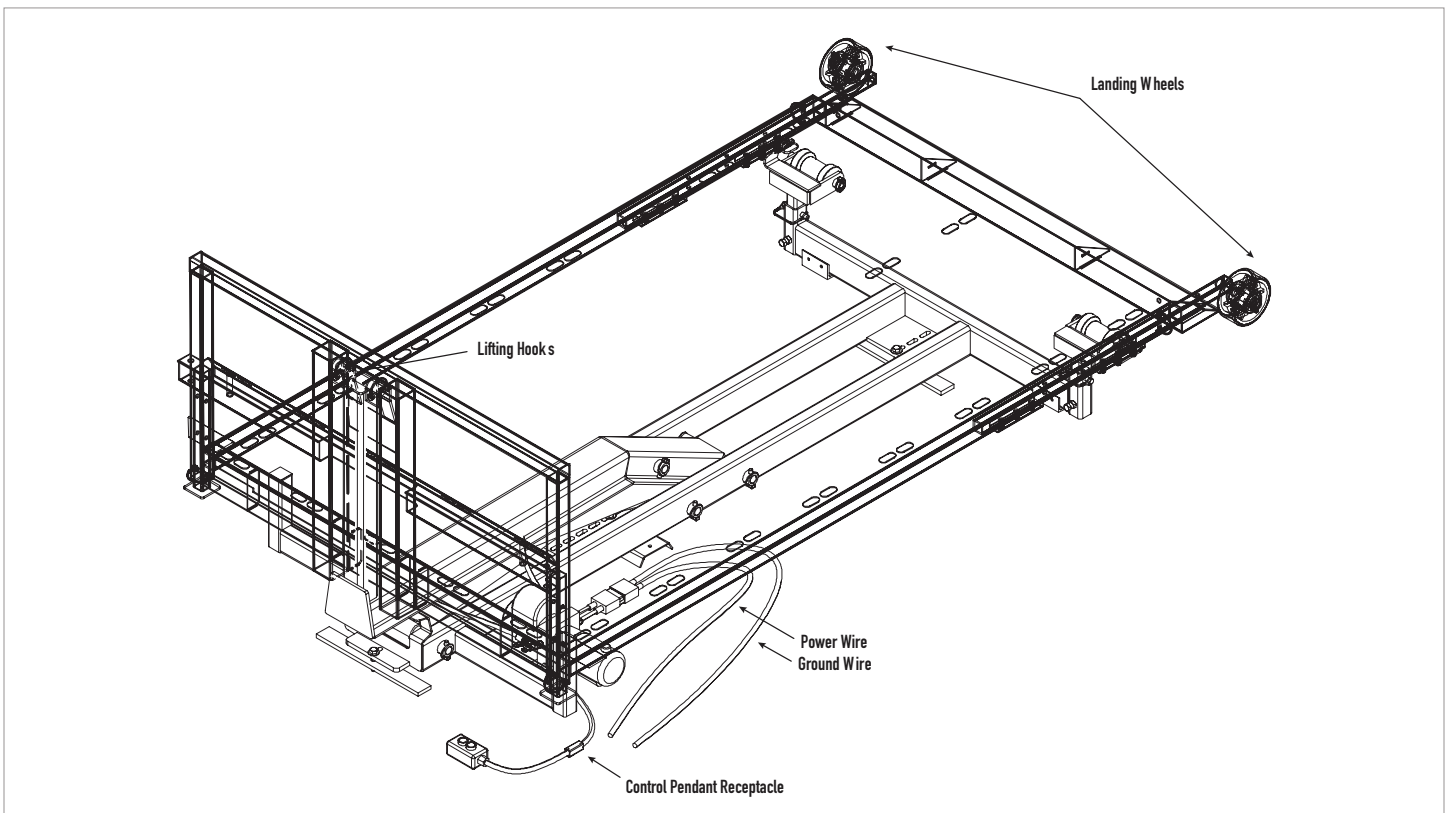

Figure 1.C

- Step 1** — Ensure there is enough space at the rear of the lift system to dismount any deck mounted to the lift system.
- Step 2** — Install the landing wheels into the deck before extending/dismounting the deck.
- Step 3** — Locate 20' power/ground cable in install kit, plug into quick disconnect on base and fastener terminals on opposite end to battery terminals (black on (-) terminal and red on (+) terminal)

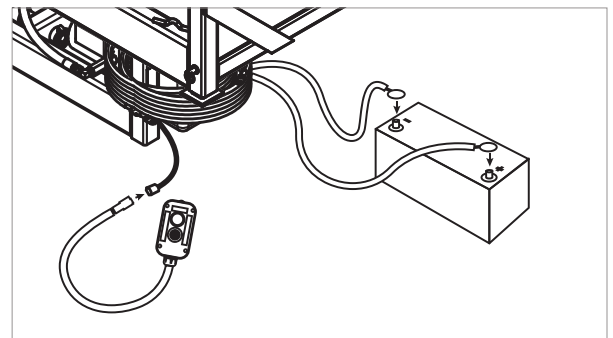

Figure 1.D

## PRE-INSTALLATION

- Step 4** — Connect the control pendant into the receptacle located on the driver's side of the lift system as shown in (Figure 1.E).
- Step 5** — Press in the white button farthest from the wire extending the lift arm "OUT" as shown in (Figure 1.E).
- Step 6** — Dismount the deck onto the ground until the deck front feet are on the ground as shown in (Figure 1.F).
- Step 7** — Locate the bulkhead bar locking pins on the lift system bulkhead and remove them from the lifting hooks as shown in (Figure 1.G).

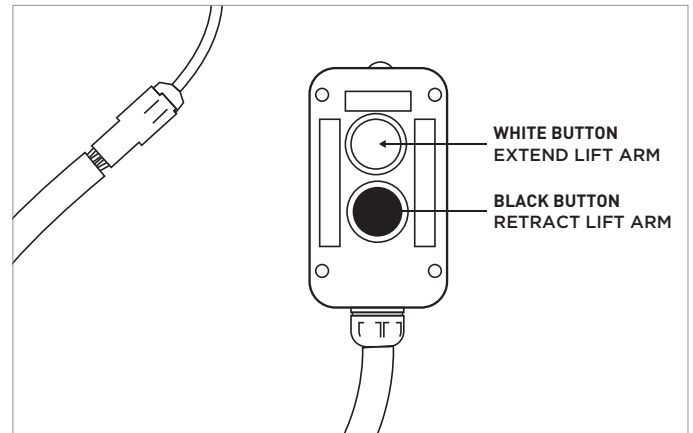

Figure 1.E

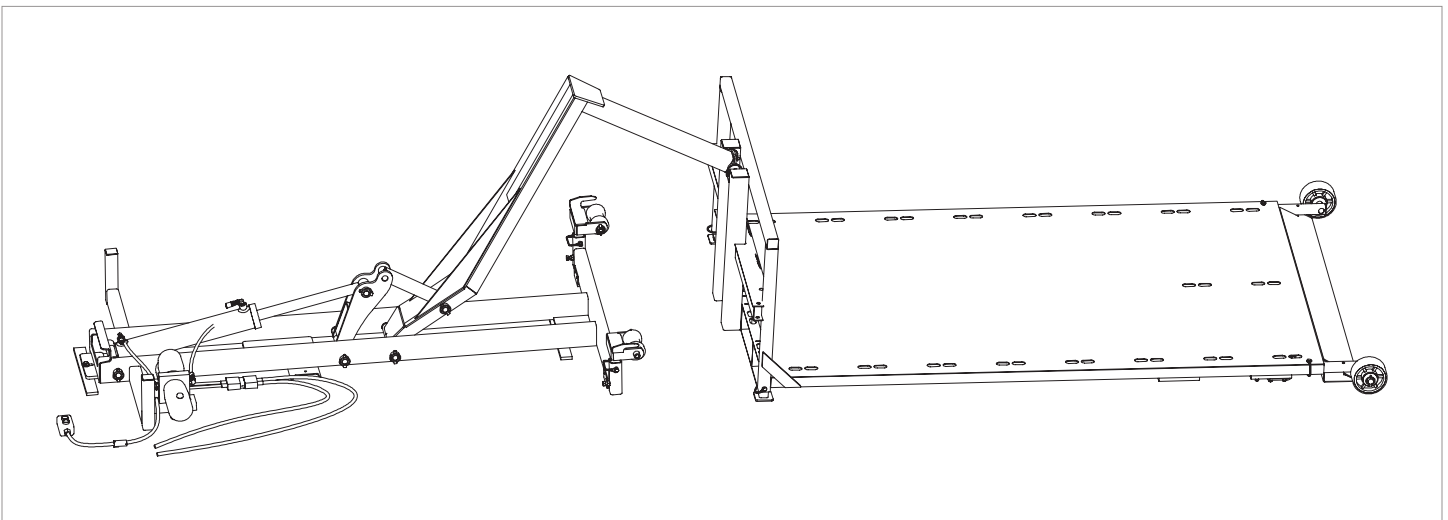

Figure 1.F

- Step 8** — Pressing the white button on the control pendant will extend the lift arm "OUT", and remove the deck from under the lifting hooks.
- Step 9** — Ensure the lift arm is free of the deck lifting hooks, and press the black button located closest to the wire, to retract "IN" the lift arm to its original state.
- Step 10** — Disconnect the control pendant and battery so the lift system is not operated accidentally.

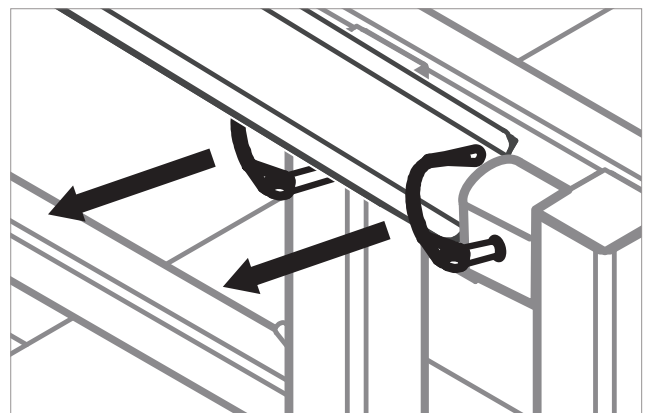

Figure 1.G

## INSTALLATION

### Bed/Box Installation Notices

**NOTICE**

The deck must be disconnected from the lift arm to install the system. The lift arm must be in the original collapsed position to allow drilling access for the mounting brackets after it is placed into the truck's bed.

**NOTICE**

The truck's tailgate must be removed to install the AmeriDeck® lift system. Refer to your truck's manufacturer manual on instructions on how to remove the tailgate.

**NOTICE**

The installer is responsible for testing that the batteries and alternator are functioning properly and meet the system requirements as stated below. Failure to meet the requirements may result in a weak or nonfunctioning system.

**NOTICE**

The installer is responsible for selecting the correct length and bed/box mounting kit as the metal composition can vary between vehicle manufacturers and will require different procedures for installation.

## INSTALLATION

### Bed/Box Installation

#### **NOTICE**

When fastening the mounting brackets, ensure to not over-tighten the brackets and distort the bed floor or vehicle's chassis cross-member or frames.

#### **NOTICE**

Drill a small pilot hole through the bed/box floor using the pre-drilled holes is recommended to ensure the drill bit clears any obstructions underneath the bed/box.

#### **WARNING**

Before drilling holes check underneath the truck's bed/box floor is clear of any objects or obstructions; such as wires, gas tanks, gas lines, brake lines, heat shields, or unnecessary cross-members under the truck floor bed/box that could be in the way of drilling or interfere with the mounting bracket.

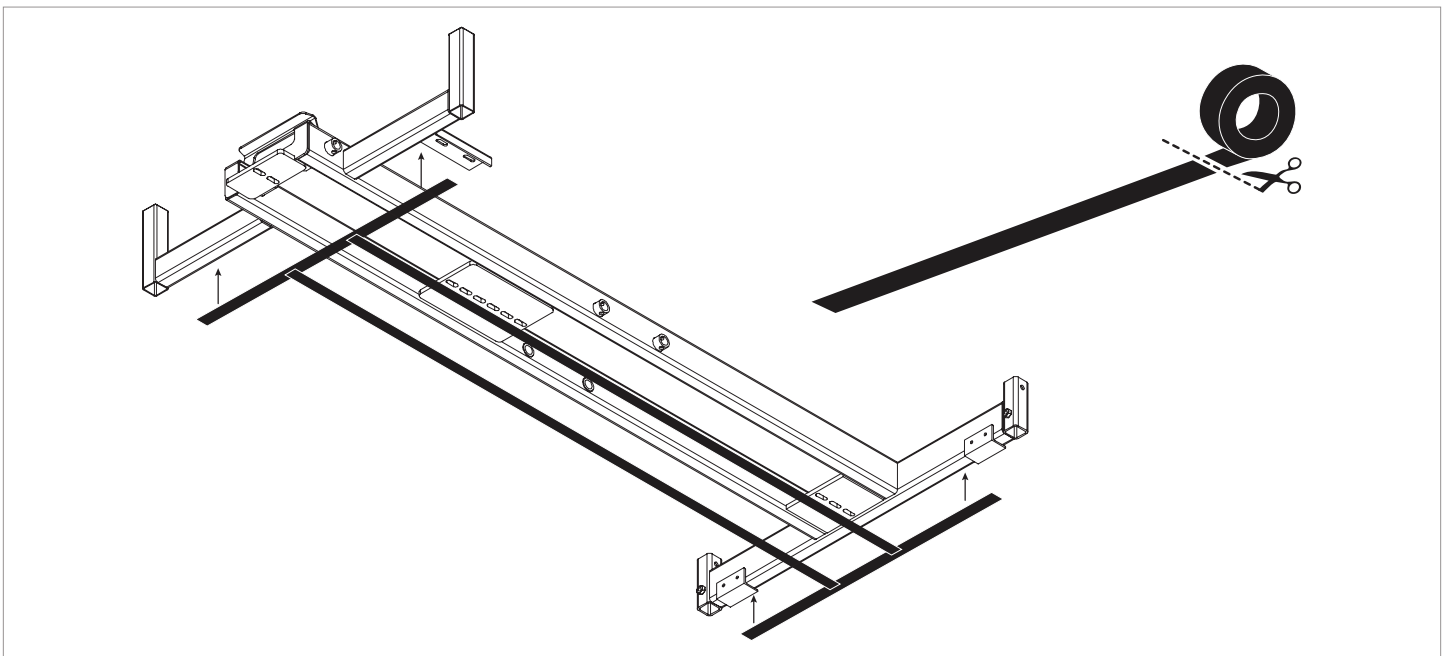

Figure 2.D

**Step 1** — Securely lift the lift system off the ground.

**Step 2** — Apply the polyethylene foam to the bottom of the lift system, as shown in (Figure 2.D). This is used to isolate the system from vibrations, as well as insulate the steel lift system from the aluminum bed/box.

#### **NOTICE**

When placing into the prepared vehicle, ensure to not slide the lift system as the foam will peel off.

**Step 3** — Securely lift the lift system in the prepared vehicle bed/box. Position the lift system in the center (left-to-right) of the vehicle.

# INSTALLATION

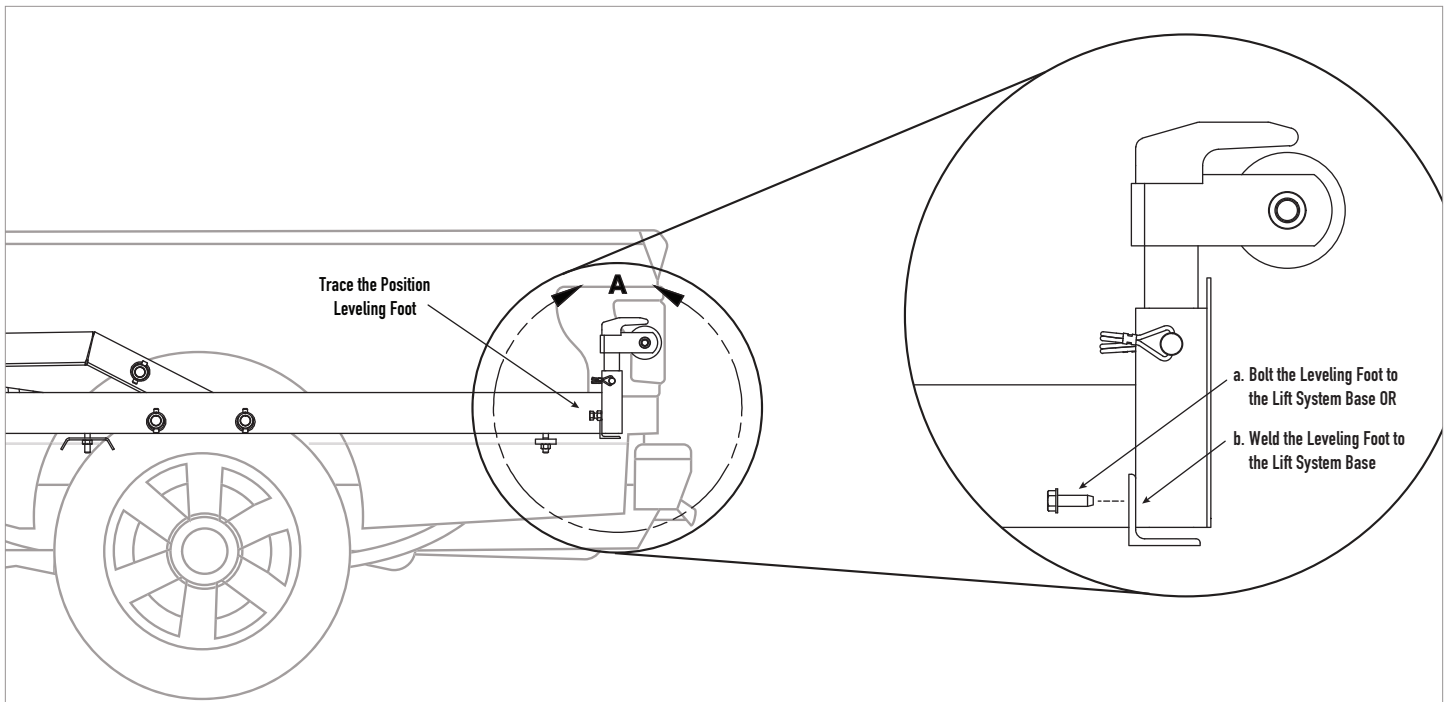

Figure 2.E

**⚠ WARNING**  
**DO NOT WELD TO THE VEHICLE CHASSIS.** This may void the vehicle or AmeriDeck® warranty, and/or may cause serious injury or death.

- Step 4** — Align front bracket with front bed cross member or frame cross member underneath bed/box. Ensure the rollers extend farther than the end of the bed to support the deck during loading/unloading process.
- Step 5** — Ensure lift system is level on the bed/box and the rails are not resting on any vehicle's bed mounting bolts.
- Step 6** — Holding the lift system onto the bed/box, place the (2) leveling feet on the bed and align it with the outside edges on the front side of the rear rail, as shown in (Figure 2.E).
- Step 7** — Attach the leveling feet by following either the welding or bolting procedure on page 15.
- Step 8** — Before drilling holes, check underneath the truck's bed/box floor and ensure it's clear of any objects or obstructions; such as wires, gas tanks, gas lines, brake lines, heat shields, etc.
- Step 9** — Drill the front end hole through the floor using the pre-drilled holes on frame mount plates located on the base with a Ø 1/2" drill bit as shown (Figure 2.G).

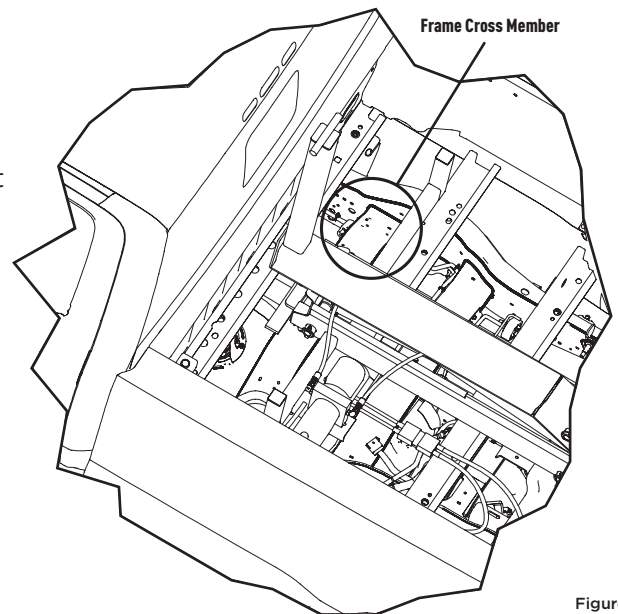

Figure 2.F

# INSTALLATION

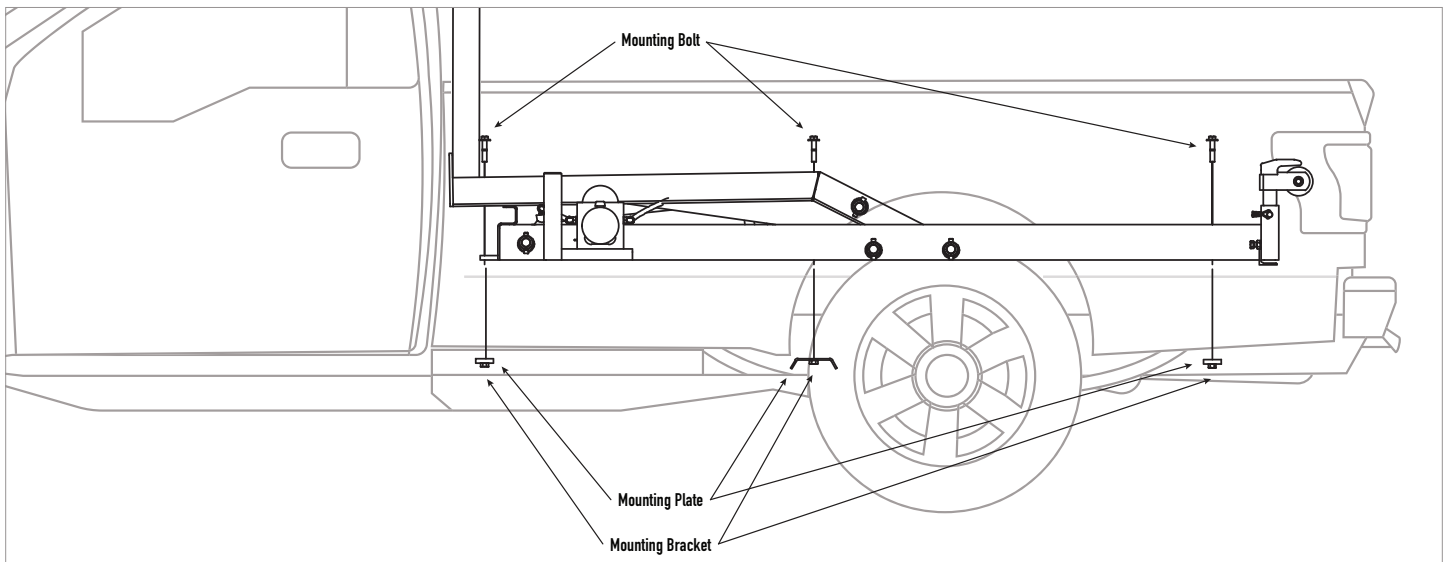

Figure 2.G

- Step 10** — Locate the front hole underneath the truck's bed/box floor and fasten but not tighten the 16" mounting bracket to the holes underneath the truck bed/box floor. Mount to the truck frame cross brace using the 7" mounting bolt from your install kit (unless no cross brace is present).
- Step 11** — Drill the rear end hole through the floor using the pre-drilled holes on frame mount plates located on the base with a  $\varnothing 1/2"$  drill bit as shown (Figure 2.G).

## REQUIREMENT

- Drilling through only the bed/box to attach the mounting plate
- $\varnothing 1/2"$  13 UNC x length varies per truck model HHCS grade 5 bolt and  $\varnothing 1/2"$  flat washer

- Step 12** — Locate the hole underneath the truck's bed/box floor and fasten but not tighten the 16" mounting bracket to the holes underneath the truck bed/box floor.

- Step 13** — With assistance of another person, tighten down bolt and washer down through the base and truck's bed/box floor, secure with torque driver with 57 lbs-ft of torque on each bolt to the mounting bracket underneath as shown in (Figure 2.H).

- Step 14** — After power is connected, lift the lift arm and install center bracket following previous steps.

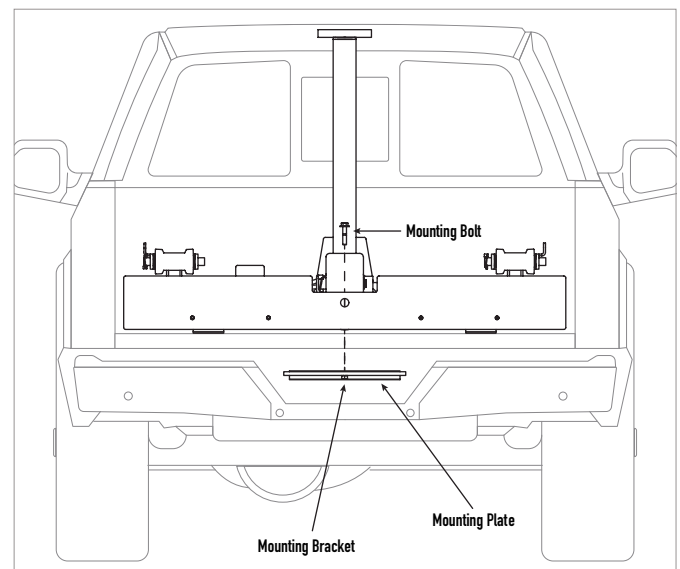

Figure 2.H

## INSTALLATION

### Welding the Leveling Feet Procedure

- Step 1** — With a scribe, trace an outline around the (2) leveling feet on the front side of the rear rail of the lift system.
- Step 2** — Remove the lift system from the truck bed/box.
- Step 3** — Shield the vehicle from any hazards from grinding/welding/painting.
- Step 4** — Grind the powder coating of the lift system previously traced out.
- Step 5** — Clamp each leveling foot to the lift system rear rails ensuring it rests level with the side of the rails.
- Step 6** — Weld the leveling feet to the lift system rear rails.
- Step 7** — Remove clamps holding the leveling feet grind the welds and clean surface.
- Step 8** — Protect components/mechanisms from over-spray by covering before applying paint.
- Step 9** — Paint any exposed or bare metal with primer coating.
- Step 10** — Paint any primed areas with multiple coats of black color that matches the coating on the lift system. Ensure proper drying times before applying another coat of paint.
- Step 11** — Apply polyethylene foam to the bottom of each of the leveling feet.
- Step 12** — Securely lift the lift system in the prepared vehicle bed/box. Position the lift system in the center of the vehicle.

### Bolting the Leveling Feet Procedure

- Step 1** — After setting the leveling feet in place on the system as shown in (Figure 2.D).
- Step 2** — Mark (4) hole locations on the leveling feet.
- Step 3** — Apply polyethylene foam to the bottom of each of the leveling feet.
- Step 4** — Drill (2) 11/32" holes in each of the leveling feet then drill (2) tapping holes with letter I or 6.3 mm drill bit into the base assembly.
- Step 5** — Secure the leveling feet to the base system with the (4) supplied Ø 5/16" x 1" self tapping screws.
- Step 6** — Protect components/mechanisms from over-spray by covering before applying paint.
- Step 7** — Paint any exposed or bare metal with primer coating.
- Step 8** — Paint any primed areas with multiple coats of black color that matches the coating on the lift system. Ensure proper drying times before applying another coat of paint.
- Step 9** — Place a Ø 1/2" 13 UNC x 2 1/2" HHCS grade 5 bolt and Ø 1/2" fat washer into a hole to keep the frame in position before drilling the second hole located on the front of the base.

## INSTALLATION

### Installation of Ground Wire

#### **NOTICE**

Ensure the ground wire from the battery terminal to the chassis has been disconnected before beginning installation of the power wire onto lift system.

- Step 1** — Ensure the vehicle is turned off and batteries are disconnected before continuing steps to install the in-cab harness.
- Step 2** — Drill (2) 9/16" holes into either the floor of the bed/box or cab-side wall.
- Step 3** — Locate the 20' power/ground attached to the quick disconnect.
- Step 4** — Route both power and ground from the lift system either through the bed floor/wall up to the battery-side of the engine compartment. Use grommets to protect the wires from the holes' sharp edges.
- Step 5** — Ensure to secure the power and ground wire cable along the vehicle chassis frame and engine compartment free from any pinch points or moving components that may result in a weak or non-functioning system.
- Step 6** — Fasten the end of the ground wire to the battery (-) terminal connector.
- Step 7** — Fasten the end of the power wire to the circuit breaker (aux load post).

### Installation of the Circuit Breaker

- Step 1** — Ensure the vehicle is turned off and batteries are disconnected before continuing steps to install the power wire.
- Step 2** — Position and fasten the provided circuit breaker near the battery less than 18" from the truck battery.
- Step 3** — Fasten 18" (1.5') # 2 gauge battery/circuit cable to the battery line post of the circuit breaker and then fasten the other end of the battery (+) terminal connector.
- Step 4** — Spray all electrical terminals and connections with corrosion resistant grease (such as white lithium grease or other equivalent dielectric grease).
- Step 5** — Use the (5) rubber loop straps & several additional self-tapping screws to secure the power and ground wires routed underneath the truck and through the engine compartment.
- Step 6** — Ensure to secure all wires cable along the vehicle chassis free from any pinch points, exhaust heat or moving components that may result in a weak or non-functioning system.



## INSTALLATION

### FMVSS Camera Compliance

#### **! WARNING**

In accordance with FMVSS 111, a rear vision system will need to be installed or adapted to the existing system supplied with the vehicle.

**Step 1** — A rear vision system will need to be installed, or adapted to the existing system supplied with the vehicle.

**Step 2** — Follow the instructions to indicated in your vehicle's manufacturer manual on how to remove the camera from the tailgate, if applicable. Adapt the camera system with additional components not provided with lift system.

### Lubricate the Lift System

Lubricate the following locations with either run-out or marine grease, as shown in (Figure 2.I).

#### **! NOTICE**

Lubrication is vital to preventing premature wear as this may result in the hoist system malfunction or system failure.

### Grease Fitting Locations

- Grease the two keel roller shafts located at the rear of the lift system
- (3) Grease fittings are located along the system linkage
- A grease fitting is located on the bottom end of the lift arm
- (2) Grease fittings are located on both of the ends of hydraulic pump cylinder

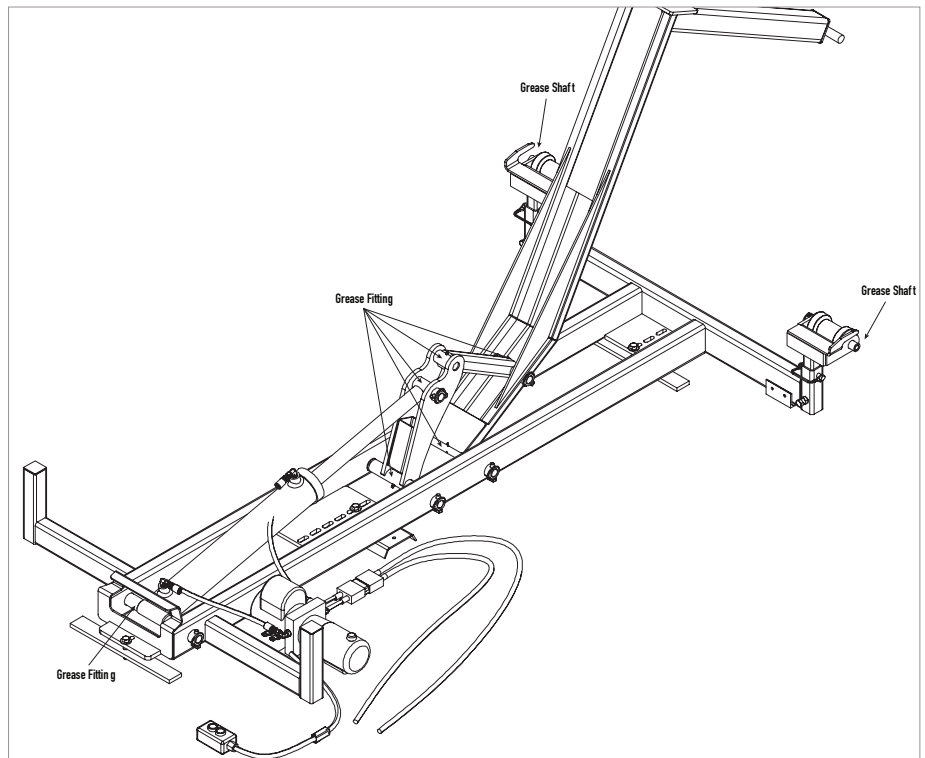

Figure 2.I

## INSTALLATION

### Prime the Hydraulic System

- Step 1** — Remove the breather cap from the reservoir located on the hydraulic power pack.
- Step 2** — Ensure the reservoir is full of hydraulic fluid.
- Step 3** — Connect the control pendant into the receptacle located on the driver's side of the lift system.
- Step 4** — Press in the white button farthest from the wire activating the lift arm "OUT" to farthest point.
- Step 5** — Quickly cycle the hoist system "IN" and "OUT." Repeat this a minimum of (15) times to remove any air pockets trapped in the hydraulic lines and cylinder.
- Step 6** — Retract the lift arm "IN" by pressing the black button.
- Step 7** — Ensure the lift arm is retracted before adding more fluid to the reservoir.
- Step 8** — Top off the hydraulic reservoir when the hydraulic system is completely primed. Leave a minimum of a 1/2" void in the tank to allow the hydraulic oil to move during operation.
- Step 9** — Place and tighten the breather cap on the reservoir.

### Remove the Lift Arm

This is only if needed for maintenance. It is not standard to remove the lift arm during installation of the system.

- Step 1** — Raise lift arm to vertical position as shown in (Figure 2.K) and secure this in place (this way when pins are removed lift arm does not swing and cause injury).
- Step 2** — Remove lynch pin and Ø 1" pin from upper lift arm pivot bushing.
- Step 3** — Remove lynch pin and Ø 1" pin from lower lift arm pivot bushing.

### Attach the Lift Arm

This is only if needed for maintenance. It is not standard to remove the lift arm during installation of the system.

- Step 1** — Connect the control pendant into the receptacle located on the driver's side of the lift system.
- Step 2** — Press in the white button farthest from the wire extending the lift arm "OUT" a minimum of 6" from the hydraulic cylinder shaft, being careful to protect the exposed shaft from scratches.
- Step 3** — Lift and set the lift arm lower pivot between the frame rails at the rear most pair of bushings, as shown in (Figure 2.J).
- Step 4** — Insert the pin through the outer tubes and lift arm bushings. Secure with lynch pin.
- Step 5** — Similarly, insert and secure pins between the linkage and the lift arm.
- Step 6** — Grease any new connections before slowly toggling the system to ensure desired movement.

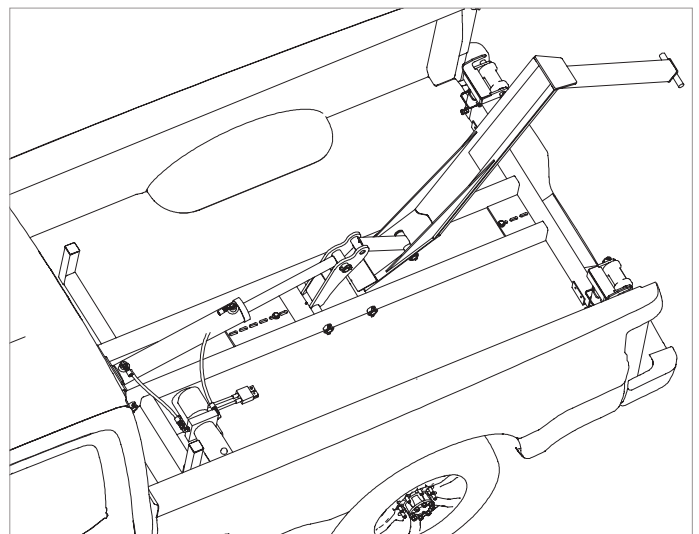

Figure 2.K

## OPTIONAL INSTALLATIONS

### Wireless Remote Control Pendant

#### **NOTICE**

These instructions for installing wireless remote control pendant are intended to be a general guide to help the installer. The wireless remote kit will require additional wiring, components, and connectors for the ground/power wire.

#### **WARNING**

This Installation will require modifying the original wiring of the lift system. This will require purchasing a new control pendant harness and installing according to its original specifications. Refer to INSTALLATION section (page 11) for the lift system wiring diagram.

- Step 1** — Turn off vehicle by either turning the key or pressing the vehicle start/stop button without pressing on the brake pedal.
- Step 2** — Disconnect the (-) cable by safely loosening the connector nut on the battery terminal.
- Step 3** — Disconnect the (+) cable by safely loosening the connector nut on the battery terminal. Do not allow battery terminals to come in contact with either the truck components or vehicle chassis frame as this could cause a short circuit and result in fire or serious damage, injury or death.
- Step 4** — Securely route both the power (+) wire cable and ground (-) wire cable from the truck bed/box underneath the cab and to the battery compartment. Ensuring that the 10 AMP fuse is next to the battery, as shown in.
- Step 5** — Connect the power wire routed from the battery area to the (red) wire of the wireless remote receiver box with a butt connector.
- Step 6** — Connect the ground wire routed from the battery area to the (black) wire of the wireless remote receiver box with a butt connector.
- Step 7** — Cut and remove the existing control pendant pump harness plug from the hydraulic power pack.
- Step 8** — Strip 1/2" of the insulation off the wire to expose the green and red wires.
- Step 9** — Connect the wires from the hydraulic power pack to the Wireless receiver box.
- Step 10** — Fasten the ground wire routed from the wireless receiver to the (-) cable and reconnect the connector to the battery terminal.
- Step 11** — Fasten the power wire routed from the wireless receiver to the (+) cable and reconnect the connector to the battery terminal.
- Step 12** — Reference HOW TO LEARN A TRANSMITTER section on how to program the wireless remote, by following the instructions in wireless remote kit documents.

## INSTALLATION COMPLETION CHECKLIST

The installation completion checklist must be filled out by the installer after the installation is completed. If hoist system is not operating correctly, refer to INSTALLATION section (page 11) or TROUBLESHOOT section (page 26) within this installation manual.

- Check all nuts and bolts are properly torqued using the torque chart on the next page.
- Check to make sure all electrical connections and wires are tight and free from all pinching or cutting hazards, as this may lead to malfunctions or damages.
- Check all grease fittings are lubricated with either run-out or marine grease.
- Check all hydraulic fittings are free of leaks. When checking for leaks, please wear protective eye wear and gloves to protect your face and hands or body from high pressure leaks.
- Check all high pressure hoses, connected the hydraulic pump to the cylinder.
- Check all hydraulic fluids are properly filled to levels indicated and hydraulic system is primed before operation.
- Check that the batteries and fuses have been reconnected and are working properly.
- Test the functions of the control pendant are working properly
  - Press in the black button closest to the wire activating the lift arm "IN" to retract the lift arm in.
  - Press in the white button farthest from the wire activating the lift arm "OUT" to extend the lift arm out.
- Test the system to its maximum operating range by fully operating the lift arm out to its farthest point.
- Sign and initial that the vehicle is ready for operation. Please review operation manual for more information on how to properly operate the AmeriDeck® lift system.

### LIFT SYSTEM™

Serial Number: \_\_\_\_\_ Model: \_\_\_\_\_

Installer Name: \_\_\_\_\_

Installer Signature: \_\_\_\_\_

Install Date: \_\_\_\_\_

### POWERDECK™

Serial Number: \_\_\_\_\_ Model: \_\_\_\_\_

Installer Name: \_\_\_\_\_

Installer Signature: \_\_\_\_\_

Install Date: \_\_\_\_\_

### DUMPDECK™

Serial Number: \_\_\_\_\_ Model: \_\_\_\_\_





Installer Name: \_\_\_\_\_

Installer Signature: \_\_\_\_\_

Install Date: \_\_\_\_\_

# APPENDIX

## Torque Table

|       |  |      |  |      |  |      |  |      |
|-------|---|------|---|------|---|------|---|------|
| Size  | Grade 2   |      | Grade 5   |      | Grade 5   |      | 18-8 S/S  |      |
|       | COARSE  | FINE | COARSE  | FINE | COARSE  | FINE | COARSE  | FINE |
| #4*   | —   | —    | —   | —    | —   | —    | 5.2   | —    |
| #6*   | —   | —    | —   | —    | —   | —    | 9.6   | —    |
| #8*   | —   | —    | —   | —    | —   | —    | 19.8  | —    |
| #10*  | —   | —    | —   | —    | —   | —    | 22.8  | 31.7 |
| 1/4"  | 4   | 4.7  | 6.3   | 7.3  | 9   | 10   | 6.3   | 7.8  |
| 5/16" | 8   | 9    | 13  | 14   | 18  | 20   | 11  | 11.8 |
| 3/8"  | 15  | 17   | 23  | 26   | 33  | 37   | 20  | 22   |
| 7/16" | 24  | 27   | 37  | 41   | 52  | 58   | 31  | 33   |
| 1/2"  | 37  | 41   | 57  | 64   | 80  | 90   | 43  | 45   |
| 9/16" | 53  | 59   | 82  | 91   | 115   | 129  | 57  | 63   |
| 5/8"  | 73  | 83   | 112   | 128  | 159   | 180  | 93  | 104  |
| 3/4"  | 125   | 138  | 200   | 223  | 282   | 315  | 128   | 124  |
| 7/8"  | 129   | 144  | 322   | 355  | 454   | 501  | 194   | 193  |
| 1"    | 188   | 210  | 483   | 541  | 682   | 764  | 287   | 289  |

\*Size from 4-10 are in lb-in, size from 1/4 up are lb-ft

†Fine thread figures are 1-14, grade 2, 5 & 8 values are plated bolts

## DIAGRAMS

### System Diagram

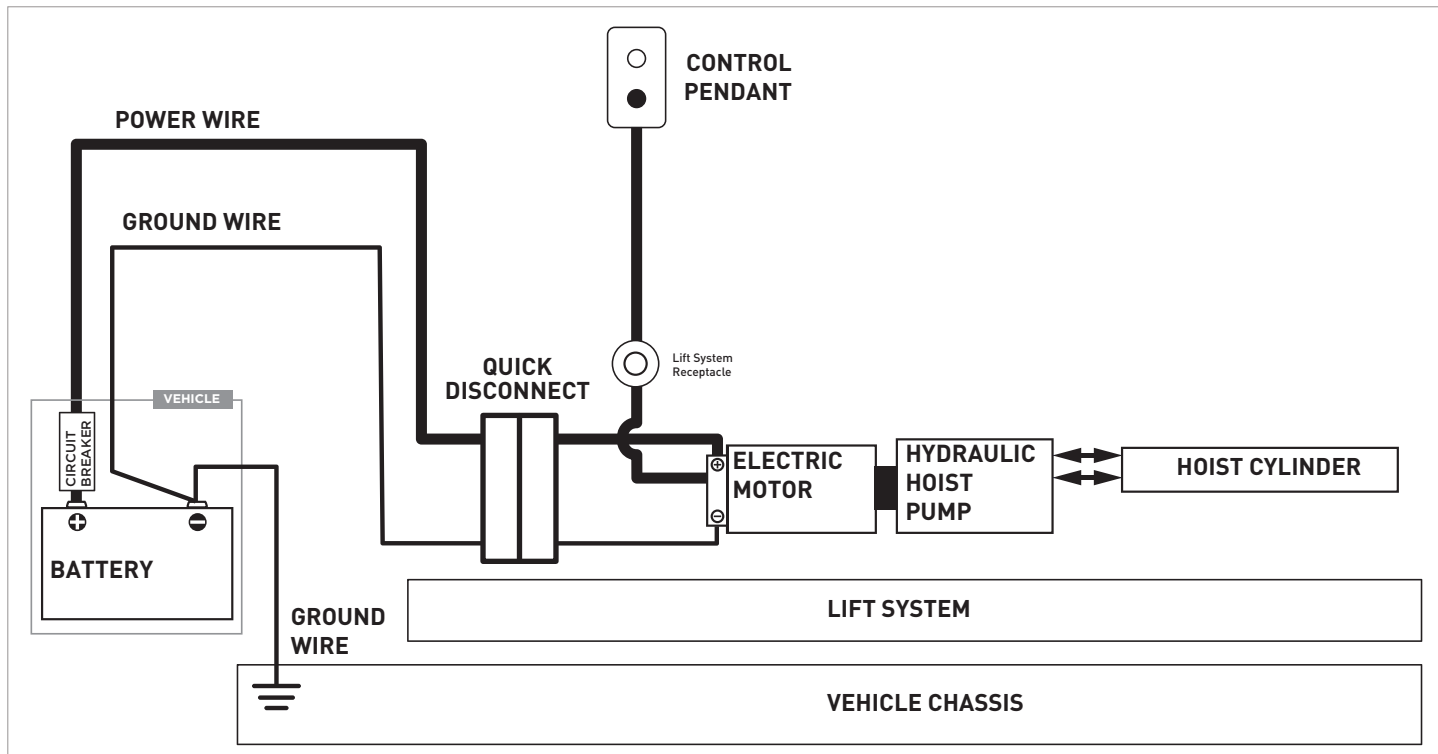

### System Diagram with Wireless Control Pendant

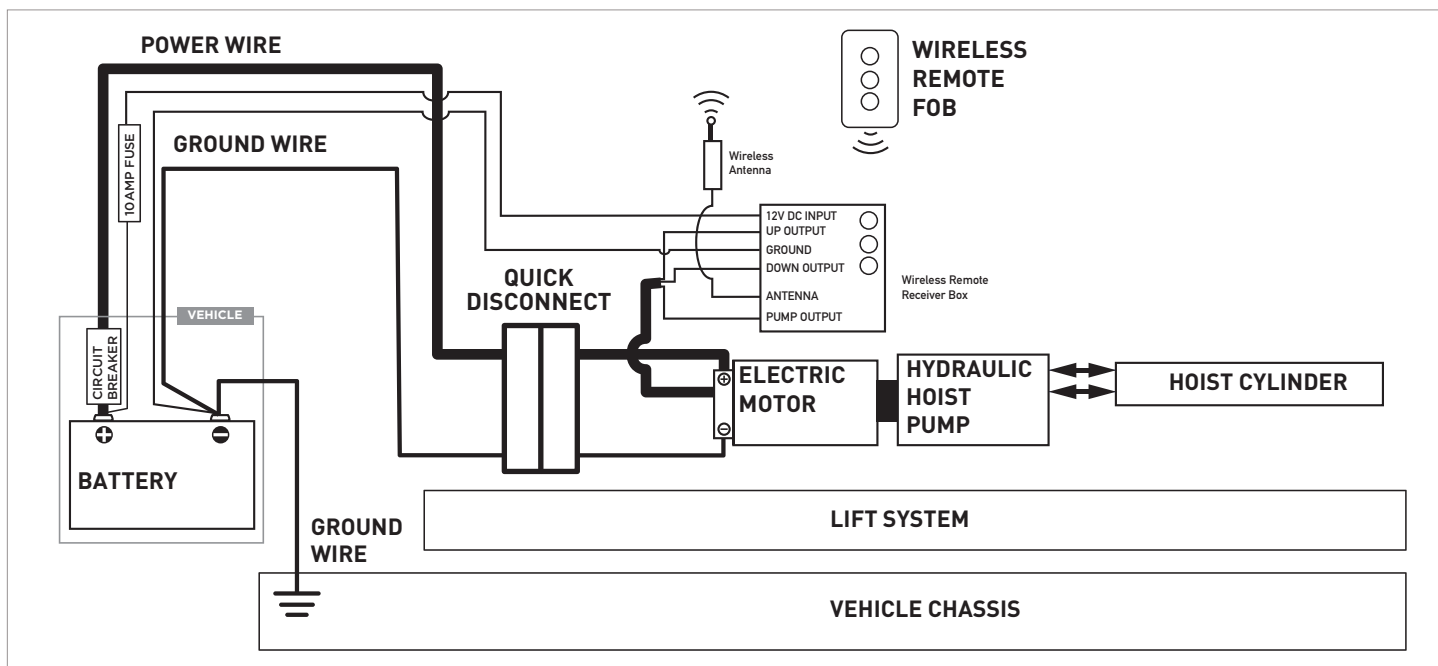

Figure 4.B

## DIAGRAMS

### Wireless Control Pendant Wiring

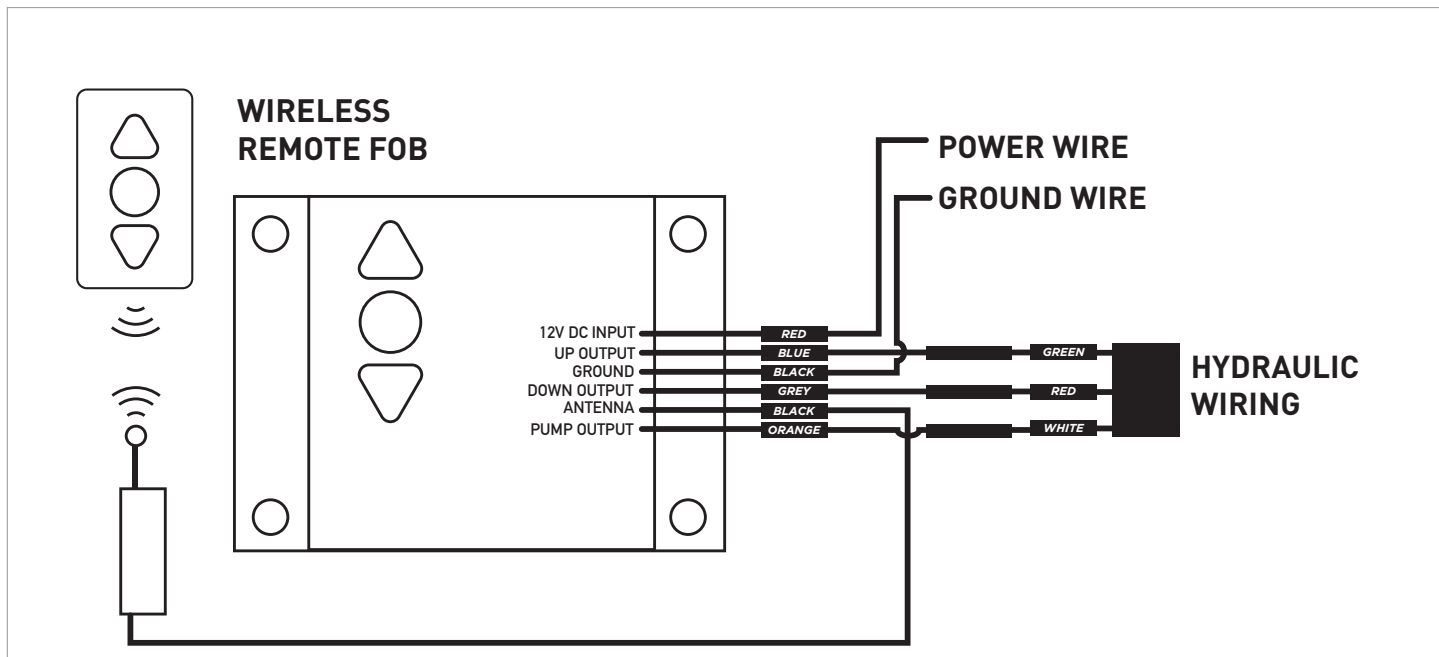

Figure 4.A

## PARTS AND COMPONENTS

|         |   |
|---------|---|
| 3180105 | Control Pendant                                   |
| 3190120 | Wireless Remote Control Pendant & Kit             |
| 3180106 | Control Pendant Pump Harness                      |
| 3180101 | Solenoid  |
| 3180102 | Moncoil - 10V DC                                  |
| 3180103 | 2 Way Valve                                       |
| 3180104 | 4 Way Valve                                       |
| 1720077 | Circuit Breaker                                   |
| 3790047 | Battery/Circuit Breaker Wire                      |
| 3790052 | 20' Power/Ground Cable with Quick Disconnect      |
| 3790053 | 48" Power/Ground Cable with Quick Disconnect      |
| 3180128 | Hydraulic Pump with Control Pendant               |
| 5080105 | 8' Lift System Hydraulic Hose Kit                 |
| 3180130 | Hydraulic Pump Motor 12V - DC                     |
| 3170834 | Hydraulic Pump Reservoir                          |
| 3170793 | Hydraulic Pump Breather Cap                       |
| 3180111 | Hydraulic Pump Cylinder                           |
| 4800502 | System Linkage                                    |
| 4850524 | Universal Lift System Install Kit                 |
| 4800500 | 6.5' Lift Arm                                     |
| 4800503 | 8.0' Lift Arm                                     |
| 4790507 | 8' Mounting Base, AMD                             |
| 4790508 | 6.5' Mounting Base, AMD                           |
| 5000516 | Passenger Side Keel Roller with Pin and Shaft Kit |
| 5000517 | Driver Side Keel Roller with Pin and Shaft Kit    |
| 5000514 | Passenger Side Keel Roller Weldment               |
| 5000515 | Driver Side Keel Roller Weldment                  |
| 1600077 | Keel Roller                                       |

|         |  |
|---------|--|
| 4600535 | Rear 16" Install Plate                         |
| 4600567 | Prevent Mounting Plate                         |
| 5000524 | Extendable Wheel Bar Assembly                  |
| 5000523 | Extendable Wheel Bar Weldment                  |
| 1600074 | Bulkhead, Deck Foot, and Wheel Bar Locking Pin |
| 1600089 | 6" Roller Wheel with Roller Bearing            |
| 4210126 | 3-Wheel Vehicle Wheel Stop                     |
| 5001000 | Universal Wheel Chock                          |
| 5080101 | Deck Foot Kit                                  |
| 4790501 | Deck Foot                                      |
| 5030308 | 12" Standard Deck Extension                    |
| 5030311 | 18" Deck Extension                             |



# PARTS DIAGRAM

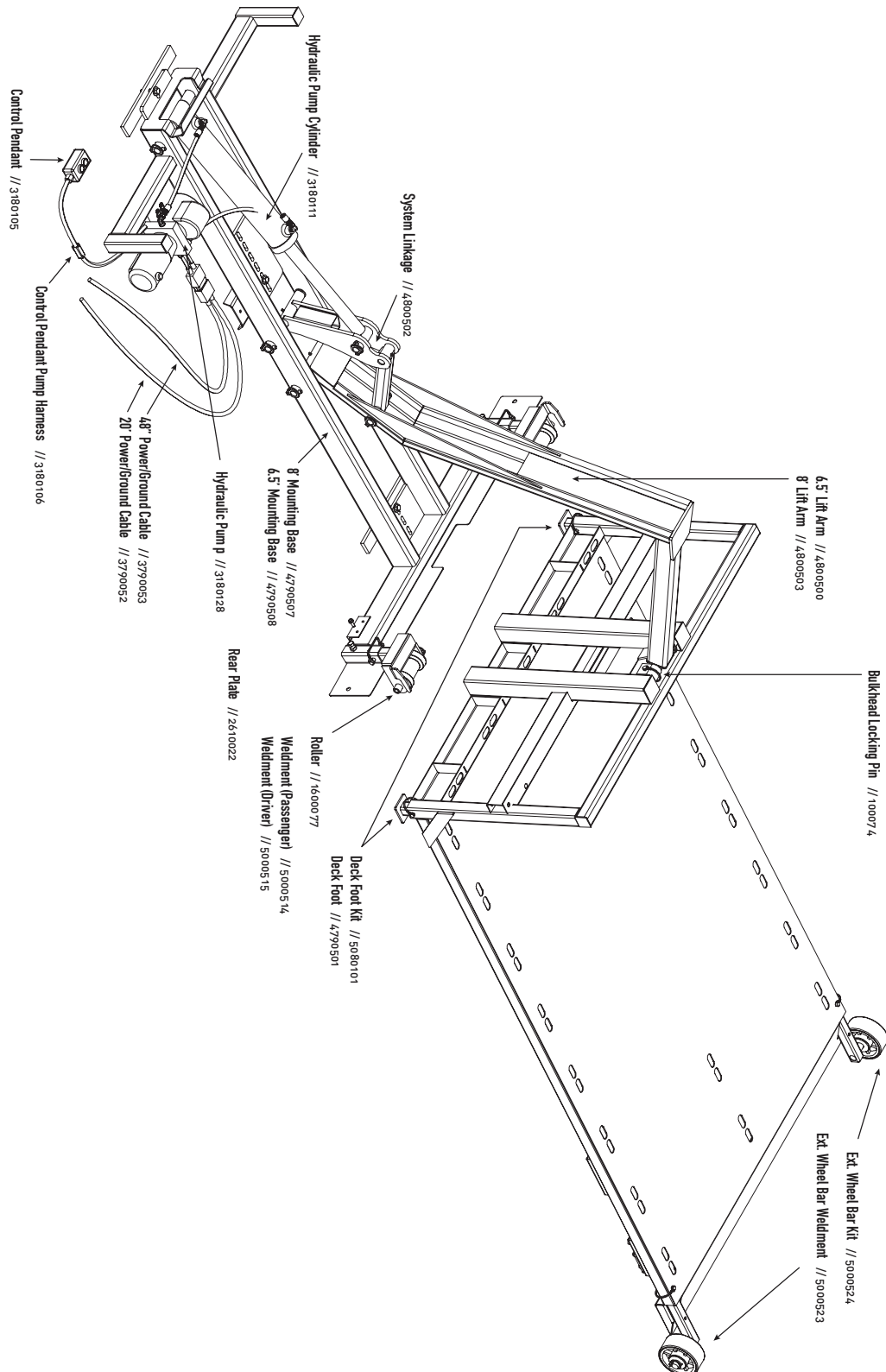

## TROUBLESHOOTING

| PROBLEM/ISSUE                                     | REASON   | SOLUTION  |
|---|--|---|
| Deck will not load or unload                      | <ul style="list-style-type: none"> <li>• Bad wire within the control pendant</li> <li>• 12V DC supply disconnected</li> <li>• Lack of oil in hydraulic tank</li> <li>• If deck will not only load or not only unload then indicates a bad coil</li> <li>• If the pump is not running and no noise is happening then bad solenoid</li> <li>• Exceeded payload capacity of lift system</li> <li>• Foreign obstruction between lift arm, deck or the base.</li> <li>• Broken or cut hydraulic line to C1 or C2 ports</li> </ul> | <ul style="list-style-type: none"> <li>• Trace the damaged wire from the pendant and fix damaged wire(s)</li> <li>• Check fuse(s), if bad replace fuse(s) and reconnect battery.</li> <li>• Fill the hydraulic tank and check for leaks or clogged breathers.</li> <li>• Replace coil</li> <li>• Replace the solenoid</li> <li>• Remove part of the payload from the loaded deck or shift load towards rear of deck</li> <li>• Remove any foreign object</li> <li>• Fix or repair hydraulic line leaks or breaks</li> </ul> |
| Fluid leaks from hydraulic tank                   | <ul style="list-style-type: none"> <li>• Clogged breather cap</li> <li>• Valve stuck part way "IN"</li> <li>• Load raises lift arm cylinder faster than pump can receive oil to the tank</li> </ul>  | <ul style="list-style-type: none"> <li>• Clean breather cap</li> <li>• Take the valve out and look for foreign objects, look at the coils</li> <li>• Load too heavy</li> </ul>  |
| Deck will not respond to control pendant          | <ul style="list-style-type: none"> <li>• Control pendant disconnected</li> <li>• If deck will operate in one direction (loading or unloading) then bad coil</li> <li>• If the pump is not running nor make any noise then indicates a non-functioning solenoid</li> <li>• 12V DC power is disconnected</li> <li>• Weak or missing battery</li> </ul>   | <ul style="list-style-type: none"> <li>• Reconnect control pendant</li> <li>• Replace coil</li> <li>• Replace solenoid</li> <li>• Reconnect 12VDC supply. Check fuses, if bad replace fuses.</li> <li>• Test battery with volt meter if bad replace the batteries. Review vehicle battery requirements have been installed</li> </ul>   |
| System is sluggish or deck will not return to bed | <ul style="list-style-type: none"> <li>• Winter or cold weather</li> <li>• Check pendant connection; if pendant is loose then it may cause intermittent pump operation</li> </ul>  | <ul style="list-style-type: none"> <li>• Press and hold the button and let the pump run and will warm fluid up and start working as normal</li> <li>• Unplug and plug the control pendant in to make sure it is fully connected</li> </ul>  |

## NOTES



## INSTALLATION MANUAL

AmeriDeck®

607 Erie Street  
Saegertown, PA 16433  
(866) 890-2311

[www.amerideckproducts.com](http://www.amerideckproducts.com)